



NOTICE OF MEETING

Licensing Sub-Committee A

MONDAY, 7TH MARCH, 2011 at 19:00 HRS - CIVIC CENTRE, HIGH ROAD, WOOD GREEN, N22 8LE.

MEMBERS: Councillors Adamou, Demirci (Chair) and Reid

AGENDA

1. APOLOGIES FOR ABSENCE

2. URGENT BUSINESS

The Chair will consider the admission of any late items of urgent business. (Late items will be considered under the agenda item where they appear. New items will be dealt with at item 7 below).

3. DECLARATIONS OF INTEREST

A member with a personal interest in a matter who attends a meeting of the authority at which the matter is considered must disclose to that meeting the existence and nature of that interest at the commencement of that consideration, or when the interest becomes apparent.

A member with a personal interest in a matter also has a prejudicial interest in that matter if the interest is one which a member of the public with knowledge of the relevant facts would reasonably regard as so significant that it is likely to prejudice the member's judgement of the public interest **and** if this interest affects their financial position or the financial position of a person or body as described in paragraph 8 of the Code of Conduct **and/or** if it relates to the determining of any approval, consent, licence, permission or registration in relation to them or any person or body described in paragraph 8 of the Code of Conduct.

4. MINUTES (PAGES 1 - 6)

To approve the minutes of the previous meeting of the Licensing Sub Committee A held on 18 November 2010 and the unrestricted minutes of the special Licensing Sub Committee held on 17 January 2011.

5. SUMMARY OF PROCEDURE (PAGES 7 - 8)

The Chair will explain the procedure that the Committee will follow for the hearing considered under the Licensing Act 2003 or Gambling Act 2005. A copy of the procedure is attached.

6. LA BARCA, 685 HIGH ROAD, TOTTENHAM, N17 8AD (PAGES 9 - 60)

To consider an application to allow Provision of Regulated Entertainment, Provision of Late Night Refreshment and Supply of Alcohol at the premises.

7. ITEMS OF URGENT BUSINESS

To consider any new items of admitted under item 2 above.

8. EXCLUSION OF PUBLIC AND PRESS

The following item is likely to be the subject of a motion to exclude the press and public as it contains exempt information as defined in Section 100a of the Local Government Act 1972; namely information relating to any individual and information which is likely to reveal the identity of an individual.

9. EXEMPT MINUTES (PAGES 61 - 64)

To approve the exempt minutes of the meeting of the special Licensing Sub Committee held on 17 January 2011.

Ken Pryor
Deputy Head of Local Democracy &
Member Services, 5th Floor
River Park House
225 High Road
Wood Green
London N22 8HQ

Helen Chapman
Principal Committee Coordinator
(Non Cabinet Committee)
Tel: 020-8489 2615
Fax: 020-8489 2660
Email: helen.chapman@haringey.gov.uk

Friday, 25th February 2011

**MINUTES OF THE LICENSING SUB-COMMITTEE A
THURSDAY, 18 NOVEMBER 2010**

Councillors Adamou, Reid and Ejiofor

MINUTE NO.	SUBJECT/DECISION	ACTION BY
LSCA18.	WEBCASTING	
LSCA19.	ELECTION OF CHAIR Cllr Ejiofor was elected chair for the proceedings.	
LSCA20.	APOLOGIES FOR ABSENCE Apologies for absence were received from Cllr Demirci for whom Cllr Ejiofor substituted.	
LSCA21.	URGENT BUSINESS There were no items of urgent business.	
LSCA22.	DECLARATIONS OF INTEREST There were no declarations of interest.	
LSCA23.	MINUTES The minutes of the Licensing Sub-committee A meetings on 7 September 2010 and 5 October 2010 were agreed as accurate records.	
LSCA24.	SUMMARY OF PROCEDURE Noted.	
LSCA25.	BUTTERFLY SNOOKER BAR, 349C HIGH ROAD, WOOD GREEN, LONDON, N22 8JA It was advised that the applicant and his representative had reviewed before the meeting video evidence on a DVD provided by one of the objectors as part of their representation and had not put forward any objections to its showing during the proceedings. The Licensing Officer, Ms Barrett presented the report on the application for a new premises licence at Butterfly Snooker Bar, 349c High Road, Wood Green N22 8JA. The premises currently was licensed as a snooker bar with regulated entertainment but the application had been submitted to permit the premises to be operated as a music and dance venue. During the consultation period, a representation had been submitted from the Metropolitan Police. It was advised that this had since been satisfied and thereby withdrawn following agreement from the applicant	

**MINUTES OF THE LICENSING SUB-COMMITTEE A
THURSDAY, 18 NOVEMBER 2010**

to comply with the conditions put forward in relation to door supervisors and verification for proof of age determinations.

A representation had also been submitted from the Enforcement Response team. 7 letters of representation against the application had been received from local residents on the ground of public nuisance relating to concern regarding the noise and anti-social behaviour of patrons smoking and congregating outside the premises and noise from music within the premises into the early hours of the morning and littering.

In response to a question it was confirmed that the current licence was still in place but that as illustrated in the photographs, the venue was not operating as a snooker club. The new application had been submitted following an enforcement visit when the change of use came to light.

Derek Pearce from the Enforcement Response Team addressed the Committee and advised that the team considered that the application did not address the prevention of public nuisance in particular relating to noise nuisance. Following a visit to the premises last month in response to the application, the view of the team was that there was a high risk of disturbance for local residents from amplified music and people congregating outside the premises to smoke. Of particular concern was the glass frontage to the premises which would provide limited resistance to noise transmission.

It was advised that two enforcement visits had been undertaken to the premises in the current year including one in October in response to a complaint about noise from a neighbouring flat. This had resulted in the issue of a warning letter for nuisance caused by loud music from the venue. During a licensing risk assessment visit in March, it was witnessed that several conditions on the current licence were not being complied with so a further warning letter was issued.

A resident addressed the Committee and explained the incidents of noise disturbance he had experienced from the bar, particularly from loud music after 10pm and sometimes until 4am at the weekends. The noise from patrons leaving also caused disturbance, with the resident on a number of occasions having to ask people to keep the noise down. The resident stated he had no objections to the venue operating as a snooker club but had significant concerns about music noise from operation as a bar.

Hemdeth, another local resident, described to the Committee the problems she had experienced from the venue, primarily from patrons leaving the venue. Disturbances included from fights and littering of the front gardens of the apartment block from drinks cans. The disturbed sleep experienced on Friday and Saturday night caused her a significant amount of stress.

20.00 – 20.10 - a DVD filmed by a resident was played to the Committee as part of their representation.

**MINUTES OF THE LICENSING SUB-COMMITTEE A
THURSDAY, 18 NOVEMBER 2010**

Moira, another local resident, addressed the Committee and explained that noise events from the venue had become more regular from June this year. The forecourt at the front of the venue where patrons smoked was small so patrons tended to congregate on the pavement and caused an unbearable level of noise as illustrated on the film although it was commented that it did not do the situation justice.

The applicant's representative commented that the ambient noise levels on the film were also at a high level. The venue also did not sell cans of alcohol which were filmed on the DVD littering the front garden of the apartment block and so could have come from the off licence in the parade or from a nearby nightclub. It was also advised that two sets of noise insulation had been installed since the DVD was filmed. The time recorded on the DVD was disputed as the owner asserted that music was turned down after 2am.

Sarah addressed the Committee and explained that as a result of the unremitting noise emanating from the venue that she had made three calls to the out of hours service since the beginning of September. The congregation of patrons outside the venue was also a problem and their presence intimidating.

In response to questions put to the residents from the Committee it was confirmed that they felt there had been a correlation between the closure of Wood Green police station and the level of noise. It was also explained that when the venue had operated as a snooker club the noise had been tolerable but since the change of use, noise problems had become more of an issue. When asked to comment on the hours of operation applied for under the licence, the residents asserted that the premises was not suitable for operation as a music and dance venue and resultant problems with noise impacted on the quality of life of local residents.

The applicant's representative, Mr Hopkins addressed the Committee and advised that the request for provision of entertainment facilities for making music part of the application had been withdrawn. It was advised that a written dispersal policy would be drafted for use by door staff to ensure more active management of patrons leaving the premises. There were notices displayed in the premises requesting that patrons did not take drinks outside and encouraging them to leave quietly. The owner also offered to publish a number for residents to

In response to a question regarding the food van located in the forecourt of the venue it was confirmed that the vehicle had no connection to the premises and residents supported that it had not been used in recent times. It was advised that efforts should be made to remove the van.

It was confirmed that the applicant accepted the conditions proposed by the Enforcement Team with the exception of modification of the original hours of operation on the application. It was also agreed that the applicant would keep the forecourt and vicinity of the venue clear of litter

**MINUTES OF THE LICENSING SUB-COMMITTEE A
THURSDAY, 18 NOVEMBER 2010**

	<p>and take advise on structural remedies to address concerns about noise attenuation through the glass frontage.</p> <p>In response to questions from the Committee it was confirmed that the owner was aware of the responsibility to prevent nuisance.</p> <p>RESOLVED:</p> <p>The Committee carefully considered and debated the application, written and verbal representations of local residents, the responsible authorities and the applicant and also took into account the section 182 guidance and the Council's statement of licensing policy. The Committee has decided to reject the application under the objective of public nuisance. Particular note was taken of the view of the enforcement noise response team that due to the close proximity of nearby residents and a considerable amount of complaints regarding loud music and noise from people leaving the premises, the premises is not considered suitable for such use.</p> <p>The representations from the residents demonstrated potent concerns in relation to public nuisance and the Committee did not feel that the application, particularly with reference to the additional area fronted by glass, could adequately promote the licensing objectives. The new use is considered to be fundamentally different from the existing use of the premises. Although this is a new licence and the Committee considered the report on its merits, the Committee considered it would be unfair to further consider to grant a licence that would have more restrictive conditions than the licence under which they currently operate.</p>	
LSCA26.	<p>ITEMS OF URGENT BUSINESS</p> <p>There were no new items of urgent business.</p>	

**UNRESTRICTED MINUTES OF THE SPECIAL LICENSING SUB COMMITTEE
MONDAY, 17 JANUARY 2011**

Councillors Browne, Demirci and Jenks

SLSC13.	APOLOGIES FOR ABSENCE There were no apologies for absence.	
SLSC14.	URGENT BUSINESS There were no items of urgent business.	
SLSC15.	DECLARATIONS OF INTEREST There were no declarations of interest.	
SLSC16.	SUMMARY OF PROCEDURE Noted.	
SLSC17.	EXCLUSION OF PRESS AND PUBLIC RESOLVED That the press and public be excluded for the following item.	
SLSC18.	48/54 HIGH ROAD, WOOD GREEN, LONDON N22 6BS The Committee considered the application for a premises licence in respect of the above premises. It was the Committee's decision that on this occasion it would not grant a premises licence. The meeting closed at 15:15hrs.	

Cllr Ali Demirci
Chair

This page is intentionally left blank

LICENSING SUB-COMMITTEE HEARINGS PROCEDURE SUMMARY	
INTRODUCTION	
1.	The Chair introduces himself and invites other Members, Council officers, Police, Applicant and Objectors to do the same.
2.	The Chair invites Members to disclose any prior contacts (before the hearing) with the parties or representations received by them
3.	The Chair explains the procedure to be followed by reference to this summary which will be distributed.
NON-ATTENDANCE BY PARTY OR PARTIES	
4.	If one or both of the parties fails to attend, the Chair decides whether to:
	(i) grant an adjournment to another date, or
	(ii) proceed in the absence of the non-attending party.
	Normally, an absent party will be given one further chance to attend.
TOPIC HEADINGS	
5.	The Chair suggests the "topic headings" for the hearing. In the case of the majority of applications for variation of hours, or other terms and conditions, the main topic is:
	Whether the extensions of hours etc. applied for would conflict with the four licensing objectives i.e.
	(i) the prevention of crime and disorder,
	(ii) public safety,
	(iii) the prevention of public nuisance, and
	(iv) the protection of children from harm.
6.	The Chair invites comments from the parties on the suggested topic headings and decides whether to confirm or vary them.
WITNESSES	
7.	The Chair asks whether there are any requests by a party to call a witness and decides any such request.
8.	Only if a witness is to be called, the Chair then asks if there is a request by an opposing party to "cross-examine" the witness. The Chair then decides any such request.
DOCUMENTARY EVIDENCE	
9.	The Chair asks whether there are any requests by any party to introduce late documentary evidence.
10.	If so, the Chair will ask the other party if they object to the admission of the late documents.
11.	If the other party do object to the admission of documents which have only been produced by the first party at the hearing, then the documents shall not be admitted.

12.	If the other party object to documents produced late but before the hearing, the following criteria shall be taken into account when the Chair decides whether or not to admit the late documents:	
(i)	What is the reason for the documents being late?	
(ii)	Will the other party be unfairly taken by surprise by the late documents?	
(iii)	Will the party seeking to admit late documents be put at a major disadvantage if admission of the documents is refused?	
(iv)	Is the late evidence really important?	
(v)	Would it be better and fairer to adjourn to a later date?	
THE LICENSING OFFICER'S INTRODUCTION		
13.	The Licensing Officer introduces the report explaining, for example, the existing hours, the hours applied for and the comments of the other Council Services or outside official bodies. This should be as "neutral" as possible between the parties.	
14.	The Licensing Officer can be questioned by Members and then by the parties.	
THE HEARING		
15.	This takes the form of a discussion led by the Chair. The Chair can vary the order as appropriate but it should include:	
(i)	an introduction by the Objectors' main representative	
(ii)	an introduction by the Applicant or representative	
(iii)	questions put by Members to the Objectors	
(iv)	questions put by Members to the Applicant	
(v)	questions put by the Objectors to the Applicant	
(vi)	questions put by the Applicant to the Objectors	
CLOSING ADRESSES		
16.	The Chair asks each party how much time is needed for their closing address, if they need to make one.	
17.	Generally, the Objectors make their closing address before the Applicant who has the right to the final closing address.	
THE DECISION		
18.	Members retire with the Committee Clerk and legal representative to consider their decision including the imposition of conditions.	
19.	The decision is put in writing and read out in public by the Committee Clerk once Members have returned to the meeting.	

Licensing Act 2003 Sub-Committee on 7th March 2011 at 7.00pm

Report title: Application for a Premises Licence Variation at LA BARCA, 685 HIGH ROAD, TOTTENHAM, LONDON N17 8AD

Report of: The Lead Officer Licensing

Ward(s) affected Northumberland

1. Purpose

To consider an application by Erijan Cela to allow Provision of Regulated Entertainment, Provision of Regulated Entertainment and Supply of Alcohol at the premises.

2. Recommendations

- 2.1 (a) Grant the application as asked
 (b) Modify the conditions of the licence, by altering or omitting or adding to them
 (c) Reject the whole or part of the application

The Committee is asked to note that it may not modify the conditions or reject the whole or part of the application unless it is necessary to promote the licensing objectives.

Report authorised by: Robin Payne.....

 Assistant Director Enforcement Services

Contact Officer: Ms Daliah Barrett -Williams

Telephone: 020 8489 8232

3. Executive summary

For consideration by Sub Committee under Licensing Act 2003 for a new Premises licence.

4. Access to information:

Local Government (Access to Information) Act 1985

Background Papers

The following Background Papers are used in the preparation of this Report:

File: LA BARCA

The Background Papers are located at Enforcement Service, Civic Centre, High Road Wood Green N22

This page is intentionally left blank

5. REPORT**Background**

An application for a variation to a Premises Licence, by Erijan Cela in respect of La Barca, 685 High Road, Tottenham, London N17 8AD under the Licensing Act 2003.

**5.2 Details of the application being sought under the Premises Licence Variation
APP1**

Provision of Regulated Entertainment: Recorded Music

Monday to Thursday	1000 to 0030 hours
Friday	1000 to 0400 hours
Saturday	1100 to 0400 hours
Sunday	1200 to 0030 hours

**Provision of Regulated Entertainment: Live Music, Performances of Dance,
Provision of facilities for making music, Provision of facilities for dancing:**

Saturday	1100 to 0200 hours
Christmas Day and Good Friday	from 1200 to 0000

Late Night Refreshment

Monday to Thursday	2300 to 0030 hours
Friday & Saturday	2300 to 0400 hours
Sunday	2300 to 0030 hours
Christmas Day and Good Friday	from 1200 to 0000 hours

Supply of Alcohol

Monday to Thursday	1000 to 0000 hours
Friday	1000 to 0300 hours
Saturday	1100 to 0330 hours
Sunday	1200 to 0000 hours
Christmas Day and Good Friday	from 1200 to 0000 hours

Opening Hours

Monday to Thursday	1000 to 0030 hours
Friday	1000 to 0400 hours
Saturday	1100 to 0400 hours
Sunday	1200 to 0000 hours
Christmas Day and Good Friday	from 1200 to 0000 hours

General-all four licensing objectives

The premises do not allow admission after 11pm. No person under the age of 18 will be allowed to remain on the premises after 11pm. Most events on Fridays/Saturdays and Sundays are private functions.

5.3 Crime and Disorder

The premises are personally supervised and all staff are fully trained in the Licensing Act requirements—a refusal book is maintained, CCTV compliance with Police and Council requirements.

5.4 Public Safety

Fire precautions/emergency lighting and fire doors compliant.

5.5 Public Nuisance

Noise control and orderly departures from the premises monitored.

5.6 Child Protection

No children under 18 allowed on the premises after 11pm. No unaccompanied children. Staff trained to ensure supervision of children.

6. RELEVANT REPRESENTATIONS (CONSULTATION)

Responsible authorities:

6.1 Comments of Metropolitan Police

Have made representation which is now accepted and therefore withdrawn.
APP 2

6.2 Comments of Enforcement Services:

The Enforcement Response -Noise Team

A representation has been received and is included in the report at **App3**.

Food Team

Have no objections to this application.

Health and Safety

The Building Control Officer has requested satisfactory electrical test certificates and a satisfactory disabled access statement be drawn up for the premises. **APP 3A**

Trading Standards

Have no objections to this application

6.3 Fire Officer

Have no objections to this application

6.4 Planning Officer

Have no objections to this application

6.5 Comments of Child Protection Agency or Nominee

Have no objections to this application

7.0 Interested Parties

1 letter of representation has been received against this application. **APP 4**

8.0 Financial Comments

The fee which would be applicable for this application was **£190.00**

9.0 Licensing Officer comments

The premises currently operates as a restaurant /café with the ability to sell alcohol until midnight Monday to Saturday. The changes being applied for if granted would permit the premises to offer live and recorded music until 4am Friday and Saturday. Provision of facilities for dancing until 2am Friday and Saturday. Copy of current licence –**App 5**

APPENDIX 1

APPLICATION FORM

AG985706
£190

LICENSING ACT 2003
Section 34

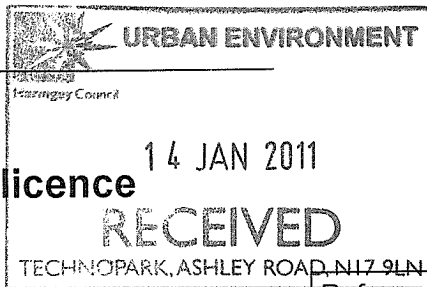

**Application to vary a premises licence
under the Licensing Act 2003**

Reference number:

(1) PREMISES No. LN00002090

PLEASE READ THE FOLLOWING INSTRUCTIONS FIRST

Before completing this form please read the guidance notes at the end of the form.
If you are completing this form by hand please write legibly in block capitals. In all cases ensure that your answers are inside the boxes and written in black ink. Use additional sheets if necessary.
You may wish to keep a copy of the completed form for your records

(2) ~~NAME~~ ERITAN CELA

being the premises licence holder, apply to vary
a premises licence under section 34 of the Licensing Act 2003 for the premises described in
Part 1 below

Premises licence number

LN 0000 2090

Part 1 - Premises details

Postal address of premises or, if none, Ordnance Survey map reference or description
"LA BARCA" (formerly "TASTE OF THE MED")
685 HIGH ROAD TOTTENHAM
N.17 8AD

Post town TOTTENHAM

Postcode N17 8AD

Telephone number at premises (if any)

0208 8855177

Non-domestic rateable value of premises

£12,250.00

Part 2 - Applicant details

Daytime contact telephone number

077 80570376

E-mail address
(optional)

celaeagle@yahoo.com

Current postal address if different from premises address
685A HIGH ROAD TOTTENHAM
N.17 8AD

Post town TOTTENHAM

Postcode N17 8AD

(1) Insert name and address of relevant licensing authority and its reference number (optional)
(2) Insert name(s) of applicant

Part 3 - Variation

Please tick yes

Do you want the proposed variation to have effect as soon as possible?

If not do you want the variation to take effect from

Day	Month	Year

Please describe briefly the nature of the proposed variation (Please read guidance note 1)

- To include live music and dancing as a licensable activity
- To extend the licensed hours for the sale and supply of alcohol, the provision of late night refreshment and of live and recorded music and dancing on Saturdays until 03.30 hours to extend the licensed hours for the sale and supply by retail of alcohol, the provision of late night refreshment and recorded music on Fridays until 03.30 the sale and supply of by retail of alcohol, the provision of late night refreshment and recorded music on Sundays to 00.30
- To extend the opening hours of the premises

Fridays	10.00	to	04.00	hours
Saturdays	11.00	to	04.00	hours
Sundays	12.00	to	00.30	hours

03.30

If your proposed variation would mean that 5,000 or more people are expected to attend the premises at any one time, please state the number expected to attend

N/A

Part 4 - Operating Schedule

Please complete those parts of the Operating Schedule below which would be subject to change if this application to vary is successful.

Provision of regulated entertainment

Please tick yes

- a) plays (if ticking yes, fill in box A)
- b) films (if ticking yes, fill in box B)
- c) indoor sporting events (if ticking yes, fill in box C)
- d) boxing or wrestling entertainment (if ticking yes, fill in box D)
- e) live music (if ticking yes, fill in box E)
- f) recorded music (if ticking yes, fill in box F)
- g) performances of dance (if ticking yes, fill in box G)
- h) anything of a similar description to that falling within (e), (f) or (g) (if ticking yes, fill in box H)

Provision of entertainment facilities for:

- i) making music (if ticking yes, fill in box I)
- j) dancing (if ticking yes, fill in box J)
- k) entertainment of a similar description to that falling within (i) or (j) (if ticking yes, fill in box K)

Provision of late night refreshment (if ticking yes, fill in box L)

Sale by retail of alcohol (if ticking yes, fill in box M)

In all cases complete boxes N, O and P

A

Plays			Will the performance of a play take place indoors or outdoors or both - please tick <input checked="" type="checkbox"/> (please read guidance note 2) Indoors <input type="checkbox"/> Outdoors <input type="checkbox"/> Both <input type="checkbox"/>
Standard days and timings (please read guidance note 6)			
Day	Start	Finish	Please give further details here (please read guidance note 3)
Mon			
			State any seasonal variations for performing plays (please read guidance note 4)
Tue			
			Non-standard timings. Where you intend to use the premises for the performance of plays at different times from those listed in the column on the left, please list (please read guidance note 5)
Wed			
Thur			
Fri			
Sat			
Sun			

B

Films			Will the exhibition of films take place indoors or outdoors or both - please tick <input checked="" type="checkbox"/> (please read guidance note 2) Indoors <input type="checkbox"/> Outdoors <input type="checkbox"/> Both <input type="checkbox"/>
Standard days and timings (please read guidance note 6)			
Day	Start	Finish	Please give further details here (please read guidance note 3)
Mon			
			State any seasonal variations for the exhibition of films (please read guidance note 4)
Tue			
			Non-standard timings. Where you intend to use the premises for the exhibition of films at different times from those listed in the column on the left, please list (please read guidance note 5)
Wed			
Thur			
Fri			
Sat			
Sun			

C

Indoor sporting events Standard days and timings (please read guidance note 6)			Please give further details here (please read guidance note 3)
Day	Start	Finish	
Mon			
Tue			State any seasonal variations for indoor sporting events (please read guidance note 4)
Wed			
Thur			Non-standard timings. Where you intend to use the premises for indoor sporting events at different times from those listed in the column on the left, please list (please read guidance note 5)
Fri			
Sat			
Sun			

D

Boxing or wrestling entertainments Standard days and timings (please read guidance note 6)			Will the boxing or wrestling entertainment take place indoors or outdoors or both - please tick <input checked="" type="checkbox"/> (please read guidance note 2)		
Day	Start	Finish	Indoors	Outdoors	Both
Mon			<input type="checkbox"/>	<input type="checkbox"/>	<input type="checkbox"/>
			Please give further details here (please read guidance note 3)		
Tue					
Wed			State any seasonal variations for boxing or wrestling entertainment (please read guidance note 4)		
Thur					
			Non-standard timings. Where you intend to use the premises for boxing or wrestling entertainment at different times from those listed in the column on the left, please list (please read guidance note 5)		
Fri					
Sat					
Sun					

E

Live music			Will the performance of live music take place indoors or outdoors or both - please tick <input checked="" type="checkbox"/> (please read guidance note 2)
Standard days and timings (please read guidance note 6)			
Day	Start	Finish	Indoors <input checked="" type="checkbox"/> Outdoors <input type="checkbox"/> Both <input type="checkbox"/>
Mon			Please give further details here (please read guidance note 3) <i>The application follows customers requests for live music on Saturdays</i>
Tue			
Wed			State any seasonal variations for the performance of live music (please read guidance note 4)
Thur			
Fri			Non-standard timings. Where you intend to use the premises for the performance of live music at different times from those listed in the column on the left, please list (please read guidance note 5)
Sat	11.00	02.00	
Sun			

F

Recorded music			Will the playing of recorded music take place indoors or outdoors or both - please tick <input checked="" type="checkbox"/> (please read guidance note 2)
Standard days and timings (please read guidance note 6)			
Day	Start	Finish	Indoors <input checked="" type="checkbox"/> Outdoors <input type="checkbox"/> Both <input type="checkbox"/>
Mon	10.00	00.30	Please give further details here (please read guidance note 3) <i>The application follows customers requests for extended licensable activities on Fridays, Saturdays and Sundays</i>
Tue	10.00	00.30	
Wed	10.00	00.30	State any seasonal variations for the playing of recorded music (please read guidance note 4)
Thur	10.00	00.30	
Fri	10.00	02.30 04.00	Non-standard timings. Where you intend to use the premises for the playing of recorded music at different times from those listed in the column on the left, please list (please read guidance note 5)
Sat	11.00	04.00	
Sun	12.00	00.30	

G

Performances of dance Standard days and timings (please read guidance note 6)			Will the performance of dance take place indoors or outdoors or both - please tick <input checked="" type="checkbox"/> (please read guidance note 2)
Day	Start	Finish	Indoors <input checked="" type="checkbox"/> Outdoors <input type="checkbox"/> Both <input type="checkbox"/>
Mon	10.00	.	Please give further details here (please read guidance note 3) <i>Customer requests for dancing on Saturday nights</i>
Tue			
Wed			
Thur			
Fri			
Sat	11.00	02.00	
Sun			
			State any seasonal variations for the performance of dance (please read guidance note 4)
			Non-standard timings. Where you intend to use the premises for the performance of dance at different times from those listed in the column on the left, please list (please read guidance note 5)

H

Anything of a similar description to that falling within (e), (f) or (g) Standard days and timings (please read guidance note 6)			Will this entertainment take place indoors or outdoors or both - please tick <input checked="" type="checkbox"/> (please read guidance note 2)
Day	Start	Finish	Indoors <input type="checkbox"/> Outdoors <input type="checkbox"/> Both <input type="checkbox"/>
Mon			Please give further details here (please read guidance note 3)
Tue			
Wed			
Thur			
Fri			
Sat			
Sun			
			State any seasonal variations for entertainment of a similar description to that falling within (e), (f) or (g) (please read guidance note 4)
			Non-standard timings. Where you intend to use the premises for entertainment of a similar description to that falling within (e), (f) or (g) at different times from those listed in the column on the left, please list (please read guidance note 5)

Provision of facilities for making music			Please give a description of the facilities for making music you will be providing <i>Live group or disco</i>
Standard days and timings (please read guidance note 6)			Will the facilities for making music be indoors or outdoors or both - please tick <input checked="" type="checkbox"/> (please read guidance note 2)
Day	Start	Finish	Indoors <input checked="" type="checkbox"/> Outdoors <input type="checkbox"/> Both <input type="checkbox"/>
Mon			Please give further details here (please read guidance note 3) <i>Customer requests for Saturday night music and dancing</i>
Tue			
Wed			State any seasonal variations for the provision of facilities for making music (please read guidance note 4) <i>Christmas Day 12.00 - 00.00</i>
Thur			
Fri			Non-standard timings. Where you intend to use the premises for provision of facilities for making music entertainment at different times from those listed in the column on the left, please list (please read guidance note 5)
Sat	<i>11.00</i>	<i>02.00</i>	
Sun			

J

Provision of facilities for dancing			Please give a description of the facilities for dancing you will be providing <i>Dancing to a live group or disco</i>
Standard days and timings (please read guidance note 6)			Will the facilities for dancing be indoors or outdoors or both - please tick <input checked="" type="checkbox"/> (please read guidance note 2)
Day	Start	Finish	Indoors <input type="checkbox"/> Outdoors <input type="checkbox"/> Both <input type="checkbox"/>
Mon			Please give further details here (please read guidance note 3) <i>Customers have requested Saturday night music and dancing</i>
Tue			
Wed			State any seasonal variations for providing dancing facilities (please read guidance note 4) <i>Christmas Day 12.00 - 00.00</i>
Thur			
Fri			Non-standard timings. Where you intend to use the premises for the provision of facilities for dancing at different times from those listed in the column on the left, please list (please read guidance note 5)
Sat	<i>11.00</i>	<i>02.00</i>	
Sun			

K

Provision of facilities for entertainment of a similar description to that falling within I or J			Please give a description of the type of entertainment facility you will be providing
Standard days and timings (please read guidance note 6)			Will the entertainment facility be indoors or outdoors or both - please tick <input checked="" type="checkbox"/> (please read guidance note 2)
Day	Start	Finish	Indoors <input type="checkbox"/> Outdoors <input type="checkbox"/> Both <input type="checkbox"/>
Mon			Please give further details here (please read guidance note 3)
Tue			State any seasonal variations for the provision of the facilities for entertainment of a similar description to that falling within I or J (please read guidance note 4)
Wed			Non-standard timings. Where you intend to use the premises for the provision of facilities for entertainment of a similar description to that falling within I or J at different times from those listed in the column on the left, please list (please read guidance note 5)
Thur			
Fri			
Sat			
Sun			

L

Late night refreshment			Will the provision of late night refreshment take place indoors or outdoors or both - please tick <input checked="" type="checkbox"/> (please read guidance note 2) Indoors <input type="checkbox"/> Outdoors <input type="checkbox"/> Both <input type="checkbox"/>
Standard days and timings (please read guidance note 6)			
Day	Start	Finish	Please give further details here (please read guidance note 3)
Mon	23.00	00.30	
Tue	23.00	00.30	State any seasonal variations for the provision of late night refreshment (please read guidance note 4)
Wed	23.00	00.30	
Thur	23.00	00.30	Christmas Day and Good Friday 12.00 to 00.00
Fri	23.00	04.30	
Sat	23.00	04.00	Non-standard timings. Where you intend to use the premises for the provision of late night refreshment at different times from those listed in the column on the left, please list (please read guidance note 5)
Sun	23.00	00.30	

M

Supply of alcohol			Will the sale of alcohol be for consumption - please tick box <input checked="" type="checkbox"/> (please read guidance note 7) On the premises <input type="checkbox"/> Off the premises <input type="checkbox"/> Both <input type="checkbox"/>
Standard days and timings (please read guidance note 6)			
Day	Start	Finish	State any seasonal variations for the supply of alcohol (please read guidance note 4)
Mon	10.00	00.00	
Tue	10.00	00.00	Christmas Day and Good Friday 12.00 to 00.00
Wed	10.00	00.00	
Thur	10.00	00.00	Non-standard timings. Where you intend to use the premises for the supply of alcohol at different times from those listed in the column on the left, please list (please read guidance note 5)
Fri	10.00	03.30	
Sat	11.00	03.30	
Sun	12.00	00.00	

N

Please highlight any adult entertainment or services, activities, other entertainment or matters ancillary to the use of the premises that may give rise to concern in respect of children (please read guidance note 8)

(This area is currently blank for handwritten input.)

O

Hours premises are open to the public Standard days and timings (please read guidance note 6)			State any seasonal variation (please read guidance note 4)
Day	Start	Finish	Christmas Day and Good Friday 12.00 to 00.00
Mon	10.00	00.30	
Tue	10.00	00.30	
Wed	10.00	00.30	
Thur	10.00	00.30	
Fri	10.00	04.00	
Sat	11.00	04.00	
Sun	12.00	00.00	

Please identify those conditions currently imposed on the licence which you believe could be removed as a consequence of the proposed variation you are seeking

Please tick yes

I have enclosed the premises licence

I have enclosed the relevant part of the premises licence

If you have not ticked one of these boxes please fill in reasons for not including the licence, or part of it, below

Reasons why I have failed to enclose the premises licence or relevant part of the premises licence

P Describe any additional steps you intend to take to promote the four licensing objectives as a result of the proposed variation:

a) General - all four licensing objectives (b, c, d, e) (please read guidance note 9)

THE PREMISES DO NOT ALLOW ADMISSION AFTER 11PM.
NO PERSON UNDER THE AGE OF 18 IS ALLOWED TO
REMAIN ON THE PREMISES AFTER 11PM. MOST EVENTS
ON FRIDAYS / SATURDAYS & SUNDAYS ARE
PRIVATE FUNCTIONS -

b) The prevention of crime and disorder

THE PREMISES ARE PERSONALLY SUPERVISED AND ALL
STAFF ARE FULLY TRAINED IN THE LICENSING ACT
REQUIREMENTS - A REFUSAL BOOK IS MAINTAINED.
CCTV COMPLIANCE WITH COUNCIL & POLICE
REQUIREMENTS

c) Public safety

FIRE
PRECAUTIONS / EMERGENCY LIGHTING &
FIRE DOORS COMPLIANT.

d) The prevention of public nuisance

NOISE CONTROL AND ORDERLY DEPARTURES FROM
THE PREMISES MONITORED.

e) The protection of children from harm

NO CHILDREN UNDER 18 ALLOWED ON THE PREMISES
AFTER 11PM. NO UNACCOMPANIED CHILDREN.
STAFF TRAINED TO ENSURE SUPERVISION OF
CHILDREN.

Please tick yes

- I have made or enclosed payment of the fee
- I have sent copies of this application and the plan to responsible authorities and others where applicable
- I understand that I must now advertise my application
- I have enclosed the premises licence or relevant part of it or explanation
- I understand that if I do not comply with the above requirements my application will be rejected

IT IS AN OFFENCE, LIABLE ON CONVICTION TO A FINE UP TO LEVEL 5 ON THE STANDARD SCALE, UNDER SECTION 158 OF THE LICENSING ACT 2003 TO MAKE A FALSE STATEMENT IN OR IN CONNECTION WITH THIS APPLICATION

Part 5 - Signatures (please read guidance note 10)

Signature of applicant (the current premises licence holder) or applicant's solicitor or other duly authorised agent. (please read guidance note 11)

If signing on behalf of the applicant please state in what capacity.

Signature

Date

Capacity ~~INDIVIDUAL~~

[Handwritten Signature]
13.01.2011
SOLICITOR

ROBIN F CLARK & CO. SOLICITORS
 198 PARROCK STREET,
 GRAVESEND, KENT DA12 1EW
 TEL: 01474 334444

Where the premises licence is jointly held signature of 2nd applicant (the current premises licence holder) or 2nd applicant's solicitor or other authorised agent. (please read guidance note 12)

If signing on behalf of the applicant please state in what capacity.

Signature

Date

Capacity

Contact name (where not previously given) and address for correspondence associated with this application (please read guidance note 13)

ROBIN F CLARK SOLICITOR
ROBIN F CLARK & CO SOLICITORS
198 PARROCK STREET

Post town *GRAVESEND*

Postcode *DA12 1EW*

Telephone number (if any) *01474 334444*

If you would prefer us to correspond with you by e-mail your e-mail address (optional)

mail@robinfclark.co.uk

Notes for Guidance

This application cannot be used to vary the licence so as to extend the period for which the licence has effect or to vary substantially the premises to which it relates. If you wish to make that type of change to the premises licence you should make a new premises licence application under section 17 of the Licensing Act.

1. Describe the premises. For example the type of premises, its general situation and layout and any other information which could be relevant to the licensing objectives. Where your application includes off-supplies of alcohol and you intend to provide a place for consumption of these off-supplies you must include a description of where the place will be and its proximity to the premises.
 2. Where taking place in a building or other structure please tick as appropriate. Indoors may include a tent.
 3. For example state the type of activity to be authorised, if not already stated, and give relevant further details, for example (but not exclusively) whether or not music will be amplified or unamplified.
 4. For example (but not exclusively), where the activity will occur on additional days during the summer months.
 5. For example (but not exclusively), where you wish the activity to go on longer on a particular day i.e Christmas Eve.
 6. Please give timings in 24 hour clock (e.g. 16:00) and only give details for the days of the week when you intend the premises to be used for the activity.
 7. If you wish people to be able to consume alcohol on the premises please tick 'on the premises', if you wish people to be able to purchase alcohol to consume away from the premises please tick 'off the premises'. If you wish people to be able to do both please tick 'both'.
 8. Please give information about anything intended to occur at the premises or ancillary to the use of the premises which may give rise to concern in respect of children, regardless of whether you intend children to have access to the premises, for example (but not exclusively) nudity or semi-nudity, films for restricted age groups, the presence of gaming machines.
 9. Please list here steps you will take to promote all four licensing objectives together.
 10. The application form must be signed.
 11. An applicant's agent (for example solicitor) may sign the form on their behalf provided that they have actual authority to do so.
 12. Where there is more than one applicant, both applicants or their respective agents must sign the application form.
 13. This is the address which we shall use to correspond with you about this application.
-

13 Jan. 2011 12:00

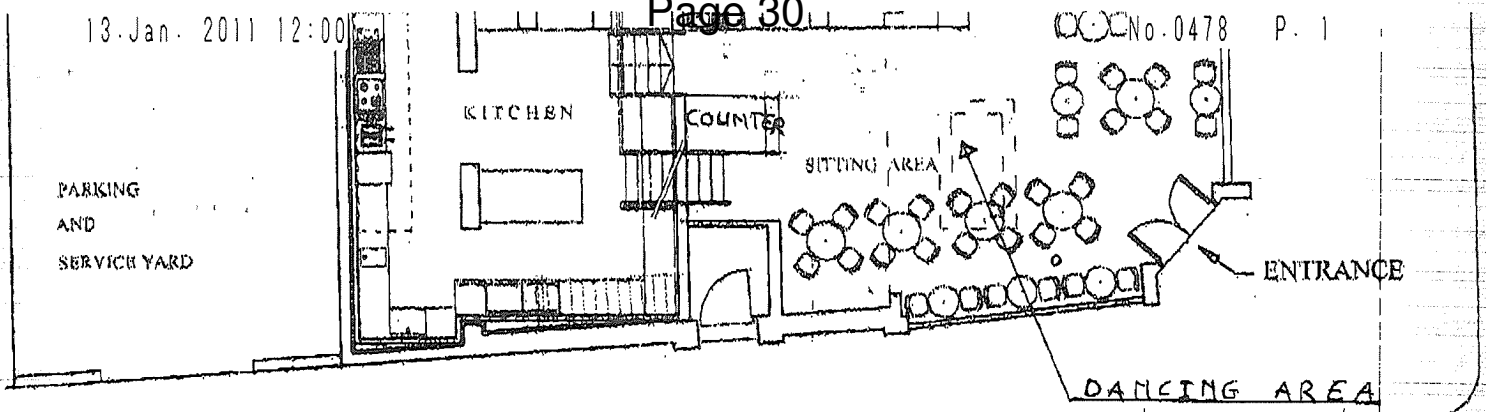

THE MED - 685 HIGH ROAD N17
GROUND & LOWER GROUND FLOOR PLAN 1:100

13-Jan-2011 12:07

No. 0480 P. 1

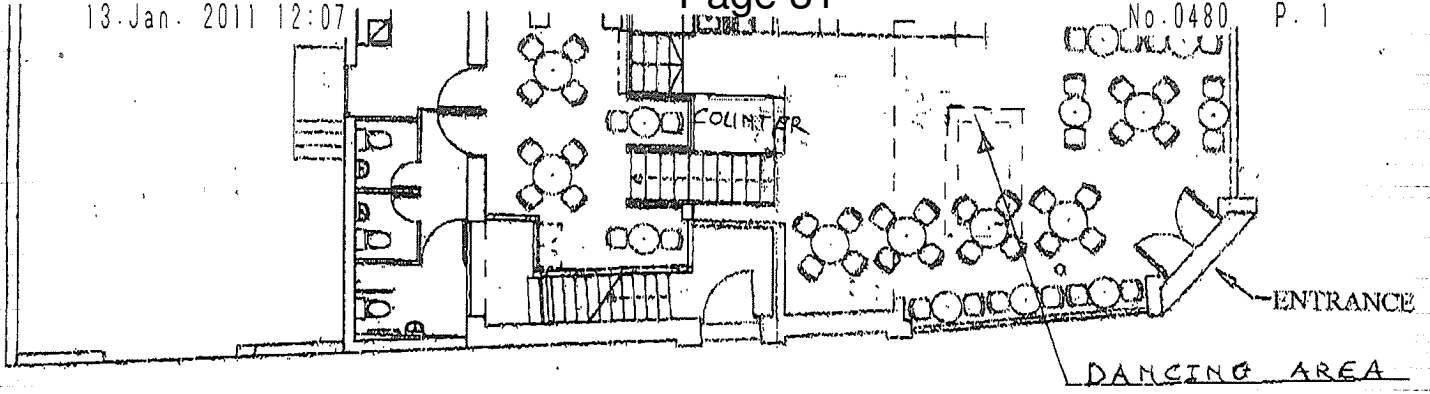

THE MED - 685 HIGH ROAD N17
GROUND & UPPER GROUND FLOOR PLAN 1:100

APPENDIX 2

METROPOLITAN POLICE REPRESENTATION – NOW ACCEPTED



Your reference:

Our reference: 8/2011

Date: 17 January, 2011

Metropolitan Police Service

Ms D.BARRETT
ENVIRONMENTAL CONTROL SERVICES
TECHNO PARK
ASHLEY ROAD
TOTTENHAM N.17

Licensing
Quicksilver Patrol Base
Western Road
Wood Green
N22 6UH

Tel: 0203 276 0150

Dear Ms. Barrett

Re:- Application to Vary a Premises Licence:-

La Barca, 685 High Road N.17

With reference to the above application Police have considered the application and wish to make the following representations.

1.This is under the Protection of Children from Harm objective.

I recommend that the following form of verification of a persons proof of age is:-

- . A valid passport
- . A photo driving licence issued in a European Union Country
- . A proof of age standard card system
- . A citizen card, supported by the home office.

2. This is under the Crime & Disorder Objective.

Digital C.C.T.V. to be installed with the capability of taking head and shoulder images of all people entering the premises. C.C.T.V. to be kept for a minimum of 28 days and be made available to police and the local authority on request. A member of staff to be trained in down loading images.

A minimum of two S.I.A. door staff to be employed on the premises on Friday and Saturday nights from 21.00 to close.

Yours Sincerely

Geoffrey Parker
Licensing
Quicksilver Patrol Base

Robin Clark & Co

Robin F. Clark & Co.
SOLICITORS AND COMMISSIONERS FOR OATHS

Robin F. Clark
Sara Gill LL.B. (Hons)
Raveen Bains LL.B. (Hons)
Richard R. Field B.A. (Hons)
(Associate Solicitor)

198 Parrock Street
Gravesend Kent
DA12 1EW
DX No. 6812 GRAVESEND

Tel 01474 334444
Fax 01474 334362

Email: mail@robinfclark.co.uk

Your Ref:

Our Ref: RFC.JM.LA BARCA

Date: 20th January 2011

Daliah Barrett-Williams
Lead Licensing Officer
The London Borough of Haringey
Techno Park
Ashley Road
Tottenham
N17 9LN

Copy by e-mail: Daliah.Barrett@haringey.gov.uk

Dear Sirs

RE: APPLICATION TO VARY A PREMISES LICENCE
"LA BARCA" 685 HIGH ROAD TOTTENHAM N17 8AD

We have taken instructions upon your letter of 17th January 2011. Our client has no objection to the recommendations set out in the letter of Geoffrey Parker, Licensing, Quicksilver Patrol Base being incorporated in the proposed Licence.

We are anxious for this matter to be concluded as soon as possible and we will of course let you have the newspaper advertisement as soon as it has appeared.

Yours faithfully

ROBIN F CLARK & CO.



Your
reference:

Our reference: 8/2011

Date: 19 January, 2011

Metropolitan Police Service

Ms D.BARRETT
Licensing
Techno Park
Ashley Road
Tottenham N.17

Licensing
Quicksilver Patrol Base
Western Road
Wood Green
N.22 6UH

Tel: 0203 – 276 - 0150

Dear Ms. Barrett

Re:- Application for a Premises Licence:-

La barca, 685 High Road N.17

With reference to the above application and our letter of representation dated the 17th of January 2011. I have received correspondence from the applicants agent agreeing to my representation.

I therefore wish to withdraw my representation.

If you require further information please do not hesitate to contact me on the above telephone number.

Yours Sincerely

Geoffrey Parker
Licensing
Quicksilver Patrol Base

c.c Robin Clark & Co

APPENDIX 3

ENFORCEMENT RESPONSE REPRESENTATION

Olson Kendra

From: Barrett Daliah
Sent: 09 February 2011 18:38
To: Olson Kendra
Subject: FW: WK/000183687 - La Barca - Variation
Follow Up Flag: Follow up
Flag Status: Red
M3PPRef: WK/000183687
M3PPUnique: 00000000E91F33D61AC1D8119D2900508B5C587D0700E3397C8C18D9D5119CF8005C

From: Tamba Lamin
Sent: 09 February 2011 16:15
To: Barrett Daliah
Subject: WK/000183687 - La Barca - Variation

Licensing Consultation - Internal Memo

To: Licensing Officer

From: Enforcement Response Officer (Noise)

Name of Officer preparing representation: Lamin Tamba

cc: Team Leader Enforcement Response, Derek Pearce

Our Reference: WK/000183687

Date: 09 February 2010

Premises: La Barca, 685 High Road, Tottenham, London, N17 8AD

Type of application: Variation

I would like to confirm that I have considered the above proposal with regard to the prevention of public nuisance on behalf of the Enforcement Response (Noise) Team & would like to make representations to the Application

Having examined this application, and inspected the premises, the applicant agreed that the premises has poor sound insulation properties and has agreed that the operating schedule does not address the prevention of public nuisance from:

- airborne entertainment noise
- Structure borne noise or vibrations from entertainment

10/02/2011

- Noise generated by patrons in external areas of the premises
- Noise generated from patrons queuing to enter
- Noise from patrons exiting the premises
- Noise generated from deliveries

However, the applicant expressed his desire to operate regulated entertainment until 02:00 as advised, then carry on providing late night refreshment until 04:00.

Based on my experience of the area and the information on the application documents I would strongly recommend that all licensable activities cease no later than 02:00. The proposed operating hours are inappropriate due to the close proximity of residential dwellings and potential of new noise sources in an area that has currently enjoys the peace and quiet after 02:00.

The noise caused by patrons exiting the premises and locating suitable transport home is likely to be detrimental to the residential amenity. This may be exacerbated by the inability of the premises to contain noise generated from regulated entertainment.

Supporting Information

There is no history of noise nuisance at the premises

If the sub-committee were to grant this application then we would recommend the following alterations/conditions to the operating schedule:

Operating hours

That the premises closes no later than 02:00

That regulated entertainment ceases at 01:30

Reason: The premises has two large glass windows/walls. One is approximately 1.5 x 2.5 metres in size and is situated on the east perimeter wall of the premises, and the other one is approximately 3-4 m x 2.5 metres in size. Both walls/windows have shutters on the outside. The ceiling also has window which is about 1x1 metre in size. All three windows are not built to attenuate noise levels that could potentially be emitted from the premises even with the shutters fully shut.

Besides, this premises has no lobbied door and this is essential if noise break-outs are to prevented.

Prevention of nuisance from noise / vibration

All doors and windows will remain closed during the licensed regulated entertainment activities or in any event after 11pm. The entrance door will be fitted with a self-closing device and staff required to

ensure that it is not propped open. A member of staff shall be made responsible to ensure the door is opened for as brief a period as possible. Where necessary adequate and suitable mechanical ventilation should be provided to public areas

Entry to the premises will be restricted to front entrance only whilst the premises is being used for regulated entertainment licensed activity

Entrance/exit from the premises whilst regulated entertainment licensable activities are ongoing shall be via a lobbied door to minimise noise breakout.

The regulated entertainment licensable activity shall conclude 30 minutes before the premises is due to close to prevent excessive noise breakout as the premises empties

Other doors e.g. fire doors

All other windows/doors/shutters will be fitted with an alarm that instructs staff when the door has been opened

Structure borne noise

All speakers are mounted on anti-vibration mountings to prevent vibration transmission of sound energy to adjoining properties

Sound limits

The licensee shall ensure that no music played in the licensed premises is audible at or within the site boundary of any residential property. This includes both live and recorded music.

All regulated entertainment amplified activity will utilise the in-house amplification system, the maximum output of which is controlled by the duty manager. Live performances that can't be routed via the in-house sound limiter will have their noise levels monitored by the Licensee to ensure that no nuisance is caused.

The level of amplified regulated entertainment shall be controlled by means of A limiting device set at a level which upon request may be agreed with the licensing authority

Outside Areas

No music will be played in, or for the benefit of patrons in external areas of the premises

No form of loudspeaker or sound amplification equipment is to be sited on or near the exterior premises or in or near any foyer, doorway, window or opening to the premises

Signs shall be displayed on the frontage requesting patrons to recognise the residential nature of the area and conduct their behaviour accordingly. The management must reserve the right to ask patrons to move inside the premises or leave if it is felt that they could be disturbing neighbours

The frontage will be closed and patrons requested to come inside the main structure of the premises at 23:00

Deliveries and collections.

Deliveries and collections associated with the premises will be arranged between the hours 08:00 and 18:30 Mon- Sat, so as to minimise the disturbance caused to the neighbours

Plant and machinery

All plant and machinery is correctly maintained and regularly serviced to ensure that it is operating efficiently and with minimal disturbance to neighbours arising from noise

Dealing with complaints

A complaints book will be held on the premises to record details of any complaints received from neighbours. The information is to include, where disclosed, the complainant's name, location, date time and subsequent remedial action undertaken. This record must be made available at all times for inspection by council officers

Patrons entering/exiting premises.

There will be no queuing outside the premises.

Where people queue to enter the premises a licensed door supervisor shall supervise and ensure the potential patrons behave in an acceptable manner

Signs should be displayed requesting patrons to respect the neighbours and behave in a courteous manner

When the premises turn out a licensed door supervisor shall supervise patrons and ensure they leave in a prompt and courteous manner, respecting the neighbours

A licensed door supervisor will be positioned on the exit door to ensure, as far as reasonably practical, that patrons do not leave drinks

A licensed door supervisor will patrol the cartilage of the premises to prevent patrons urinating in public areas in the vicinity of the premises

Prevention of nuisance from litter

Adequate receptacles for use by patrons will be provided in the local vicinity. The positioning of the receptacles will be agreed with the licensing officer

Prevention of Nuisance from Odour

All ventilation and extraction systems shall be correctly maintained and regularly serviced to ensure that it is operating efficiently and with minimal disturbance to neighbours arising from odour

Prevention of nuisance from light

Illuminated external signage shall be switched off when the premises is closed

Security lights will be positioned to minimise light intrusion to nearby residential premises.

Barrett Daliah

From: Pearce Derek
Sent: 15 February 2011 10:37
To: Licensing
Cc: Tamba Lamin
Subject: La Barca, 685 High Road, Tottenham, London, N17 8AD.
Attachments: La Barca letter November 210 alcohol.pdf; La Barca letter November 210 late night refreshment.pdf; La Barca letter November 210 regulated entertainment.pdf

Further to our representation in which we indicated that there was no history of noise nuisance at the premises I am writing to clarify the position.

On 31st October 2010 at 02:21 a complaint was received from a resident of Ruskin Road.

A visit was made at 03:40 and the premises were found to be open and playing loud live music.

The manager stated to the duty officer that they were having a private event. The officer explained that the premises should be closed by 00:30 and they have no licence for regulated entertainment. The officer requested that the music be turned down.

Following this visit the officer sent the attached letters.

Derek Pearce Team Leader
Tel 020 8489 5264
Haringey Council
Enforcement Response
Technopark
Ashley Road
London N17 9LN

Enforcement Response

Units 271-272, Lee Valley Technopark, Ashley Road, London N17 9LN
Tel: 020 8489 1000
Fax: 020 8489 5133
www.haringey.gov.uk/noise

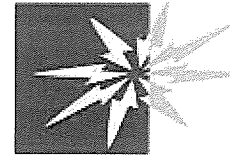

Director of Urban Environment - Niall Bolger
Head of Enforcement Service – Robin Payne

Haringey Council

Erijan Cela,
c/o La Barca
685 High Road
Tottenham
London, N17 8AD

Your ref: UE/ENF WK/000175215
Date: 2nd November 2010
Contact: Enforcement Response
Team
020 8489 1000
email: enforcement.response

Dear Sir / Madam,

Warning Letter: Licensing Act 2003

Address La Barca, 685 High Road, Tottenham, London, N17 8AD

It has been identified that the above premises, on 31st October 2010 at 03.40am were being used for the sale of alcohol outside of the hours permitted under the current license.

You are warned that this practice must cease. The license does not permit the sale of alcohol at this time

It is an offence under section 136 of the Licensing Act 2003 if a person

- (a) carries on or attempts to carry on a licensable activity on or from any premises otherwise than under and in accordance with an authorisation or
- (a) he knowingly allows a licensable activity to be carried on.

You should familiarise yourself with the activities permitted under the current License & such unauthorised use of the premises must cease immediately.

No further warnings will be issued. This Authority may seek to prosecute if future unauthorised activity is identified

It is in your own interest to ensure that you are complying with the licensing laws.

If any of the above is unclear or you require further clarification please contact the Licensing Lead Officer on 020 8489 8232.

Yours sincerely

C Buckle
Enforcement Response Team

If you have used the service in the past and would like to comment about the service you received, please complete our online survey <http://www.haringey.gov.uk/enforcementconsultations>

Enforcement Response

Units 271-272, Lee Valley Technopark, Ashley Road, London N17 9LN
Tel: 020 8489 1000
Fax: 020 8489 5133
www.haringey.gov.uk/noise

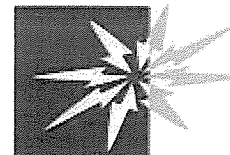

Director of Urban Environment - Niall Bolger
Head of Enforcement Service – Robin Payne

Haringey Council

Erijan Cela,
c/o La Barca
685 High Road
Tottenham
London, N17 8AD

Your ref: UE/ENF WK/000175215

Date: 2nd November 2010

Contact: Enforcement Response
Team

020 8489 1000

Email: enforcement.response

Dear Sir / Madam,

Warning Letter: Licensing Act 2003

Address: **La Barca, 685 High Road, Tottenham, London, N17 8AD**

It has been identified that the above premises on 31st October 2010 at 03.40am were being used for late night refreshment outside of the hours permitted.

The provision of late night refreshment means the supply of hot food or hot drink to the public, for consumption on or off the premises, between 11pm and 5am or the supply of hot food or hot drink to any persons between those hours on or from premises to which the public has access.

You are warned that this practice must cease.

It is an offence under section 136 of the Licensing Act 2003 if a person

- (a) carries on, or attempts to, carry on a licensable activity on or from any premises otherwise than under and in accordance with an authorisation or
- (a) he knowingly allows a licensable activity to be carried on.

You should familiarise yourself with the activities permitted under the current License if you have one. Unauthorised use of the premises must cease immediately.

No further warnings will be issued. This Authority may seek to prosecute if future unauthorised activity is identified

It is in your own interest to ensure that you are complying with the licensing laws. If any of the above is unclear or you require further clarification please contact the Licensing Lead Officer on 020 8489 8232.

Yours sincerely

C Buckle
Enforcement Response Team

Enforcement Response – Frontline Services

Units 271-272, Lee Valley Technopark, Ashley Road, Tottenham, London N17 9LN

Tel: 020 8489 1000

Fax: 020 8489 5133

www.haringey.gov.uk/noise

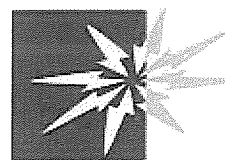

Director of Urban Environment - Niall Bolger
Head of Enforcement Service – Robin Payne

Haringey Council

Mr Erijan Cela
c/o La Barca,
685 High Road,
Tottenham,
London, N17 8AD

Your ref: UE/ENF WK/000175215

Date: 2nd November 2010

Contact: Enforcement Response
Team

020 8489 1000

Email: enforcement.response

Warning Letter: Licensing Act 2003

Address La Barca, 685 High Road, Tottenham, London, N17 8AD

It has been identified that the above premises on 31st October 2010 at 03.40am were being used for regulated entertainment which is not permitted under any current license. You are warned that this practice must cease. Regulated entertainment includes but is not restricted to playing recorded music above background level, live music and karaoke.

It is an offence under section 136 of the Licensing Act 2003 if a person

- (a) carries on or attempts to carry on a licensable activity on or from any premises otherwise than under and in accordance with an authorisation or
- (a) he knowingly allows a licensable activity to be carried on.

You should familiarise yourself with the activities permitted under any current License & such unauthorised use of the premises must cease immediately.

This Authority may seek to prosecute if future unauthorised activity is identified. It is in your own interest to ensure that you are complying with the licensing laws.

If any of the above is unclear or you require further clarification please contact the Licensing Lead Officer on 020 8489 8232.

Yours sincerely

C Buckle
Enforcement Response Team

If you would like to comment about the service you received, please complete our online survey www.haringey.gov.uk/enforcementconsultations

APPENDIX 3A

COMMENTS COVERING PUBLIC SAFETY OBJECTIVE.

MEMORANDUM

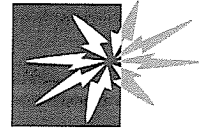

Haringey Council

Date: 4 February 2011

Tel: 020 8489 5138

Ref: BC/LL/0000/0456/LL001

To: Licensing Lead Officer
Unit 271
Lee Valley Technopark
Ashley Road
Tottenham Hale
London N17 9LN

From: Building Control
639 High Road
N17 8BD

ENTERTAINMENTS LICENSING

Licensing Act 2003

Location: 'La Barca' 685 High Road N17

Proposal: Application to vary premises licence

I refer to your email dated 14 January 2011 in respect of an application for a variation to the License at the above named premises.

Building Control in the capacity as a Responsible Authority wish to make representation under the protection of public safety objective. We have considered the application, carried out a site visit, and have noted the following matters which are required to be completed to uphold the public safety objective:

1. Satisfactory electrical certificate to be submitted.
2. Disabled access statement should be drawn up for the premises.

Please note that a full fire safety assessment has not been carried out as this falls under the remit of the LFEPA.

Should you require any further information in this regard please do not hesitate in contacting me.

Regards,

D. Ioannou
Senior Building Surveyor

639 High Road
London N17 8BD
Tel: 020 8489 5138
Fax: 020 8489 5229
Building.Control@haringey.gov.uk

APPENDIX 4

REPRESENTATION FROM INTERESTED PARTIES

From: Mr. MPALA Mufwankolo
 614 High Road
 TOTTENHAM
 N17 9TB



Dear Sir, Madem

I would like to put and introduce a representation for the following Application, of LA BARCA, situated at 685 High Road for the following reasons:

- ① The address of this premises in the newspaper Confuse the Readers, as it is not clear if this premise is in TOTTENHAM or in Wood Green.
- ② LA BARCA is situated just 2 DOORS away from the Blue BAR which has caused big distress to local Residents.
- ③ The same people that was trading at EKUBANZ are trading at LA BARCA and this will bring back problems of shooting, and OR perturbation ~~of~~ ~~of~~

And will Create a big problem for The Safety of The area.

(4) The Same people that had been Refused permission to trade at Ekubanz have Moved to LA BARCA, and I Do not see in which Manner LA BARCA'S OWNER ~~which is not from this~~ CAN stop the spread of anti social behaviour, and provide peace of mind ~~to~~ to residents, after the Closure of Blue BAR its Neighbour and also Ekubanz its Neighbour as well, by the local authority.

(5) There is a danger that The Same people that was trading and being Customers to Ekubanz and Blue BAR Comes back with work after being authorise to use LA BARCA.

for The Reasons stated over leaf, I, Mr. M. Mufwankolo, would like to be Call and represent my self at a Hearing

(6) LA BARCA is surrounded by habitation, and there is not a free space between LA BARCA and houses behind, or opposite the ROAD in both High Rd and the Side ROAD.

(7) Police was called before to stop noise from LA BARCA, while performing live music by the same people who was at EKUBANZ before its closure.

If This is the Case.

Yours Sincerely,

Mr. M. MURKANKOLO

AKA N. JUAMI



His Reverend Honor

APPENDIX 5

COPY OF CURRENT LICENCE.

LICENSING ACT 2003
Sec 24



HARINGEY COUNCIL

PREMISES LICENCE

Receipt: AG766850

Premises Licence Number: LN00002090

This Premises Licence has been issued by:

The Licensing Authority, London Borough of Haringey,
Civic Centre, High Road, Wood Green,
London, N22 8LE

Signature: 

Date: 24TH November 2005

Part 1 - PREMISES DETAILS

Postal Address of Premises or, if none, Ordnance Survey map reference or description:

TASTE OF THE MED
685 HIGH ROAD
TOTTENHAM
N17 8AD

Telephone: 020 8885 3300

Where the Licence is time limited, the dates:

N/A

Licensable activities authorised by the Licence:

Supply of Alcohol

Provision of Late Night Refreshment

The times the Licence authorises the carrying out of licensable activities:

Supply of Alcohol

Monday to Friday 1000 to 0000

Saturday 1100 to 0000

Sunday 1200 to 2330

Christmas Day & Good Friday 1200 to 2330

Provision of Late Night Refreshment

Monday to Saturday 2300 to 0030

Sunday 2300 to 0000

New Years Eve licensable activities from the start of permitted hours on 31 December until the start of permitted hours on 1 January.



LICENSING ACT 2003
Sec 24



HARINGEY COUNCIL

The opening hours of the premises:

Monday to Friday	1000 to 0030
Saturday	1100 to 0030
Sunday	1200 to 0000
Christmas Day & Good Friday	1200 to 0000

New Years Eve opening hours from the start of permitted hours on 31 December until the start of permitted hours on 1 January.

Where the Licence authorises supplies of alcohol whether these are on and/or off supplies:

Supply of alcohol for consumption ON the premises, ancillary to a meal.

Part 2

Name, (registered) address, telephone number and e-mail (where relevant) of holder of Premises Licence:

Erijan Cela
116 West Green Road
London
N15 5AA

Registered number of holder, for example company number, charity number (where applicable):

Name, address and telephone number of designated premises supervisor where the Premises Licence authorises the supply of alcohol:

Erijan Cela
116 West Green Road
London
N15 5AA

Personal Licence number and issuing authority of personal licence held by designated premises supervisor where the Premises Licence authorises for the supply of alcohol:

Personal Licence Number LN/00002090
The London Borough of Haringey





HARINGEY COUNCIL

Annex 1 -Mandatory Conditions

(2) Supply of alcohol: No supply of alcohol may be made under the premises licence-

- (a) at a time when there is no designated premises supervisor in respect of the premises licence or
- (b) at a time when the designated premises supervisor does not hold a personal licence or his personal licence is suspended.

(3) The second condition is that every supply of alcohol under the premises licence must be made or authorised by a person who holds a personal licence.

RESTAURANT CONDITION

Intoxicating liquor shall not be sold or supplied on the premises otherwise than to persons taking table meals there and for consumption by such a person as an ancillary to his meal.

Suitable beverages other than intoxicating liquor (including drinking water) shall be equally available for consumption with or otherwise as an ancillary to meals served in the licensed premises.





Annex 2 - Conditions consistent with the Operating Schedule

This licence has been granted upon the conversion, under Schedule 8 to the Licensing Act 2003, of the existing justices' license and such rights and restrictions that applied thereto are hereby incorporated into this license, subject to any terms herein to the contrary and / or any limitation or restriction imposed by the Licensing Act 2003 or any subsequent amendment thereto.

THE PREVENTION OF CRIME AND DISORDER

Premises will discourage anti-social behaviours, crime and disorder by keeping a close eye on its customers and store vicinity.

PUBLIC SAFETY

Management will be responsible for public safety. Premises will have Fire Risk Assessment, Health and Safety and personal capacity plans in place and these will be made available to local authorities upon request. Premises will have disability access.

THE PREVENTION OF PUBLIC NUISANCE

Signage will be displayed asking that customers leave the premises quietly and respect the neighbours.

Staff will be trained to recognise and deal with public nuisance. Premises will discourage irresponsible consumption and behaviour in the vicinity of the shop.

THE PROTECTION OF CHILDREN

Premises will not have any gambling amusement machines on the premises.

Alcohol may only be sold to individuals over the age of 18 with valid proof of identification with one of the following:

- A valid passport
- A photo driving license issued in a European Union Country
- A proof of age standard card system
- A citizen card, supported by the Home Office





HARINGEY COUNCIL

Annex 3 - Conditions attached after a hearing by the licensing authority

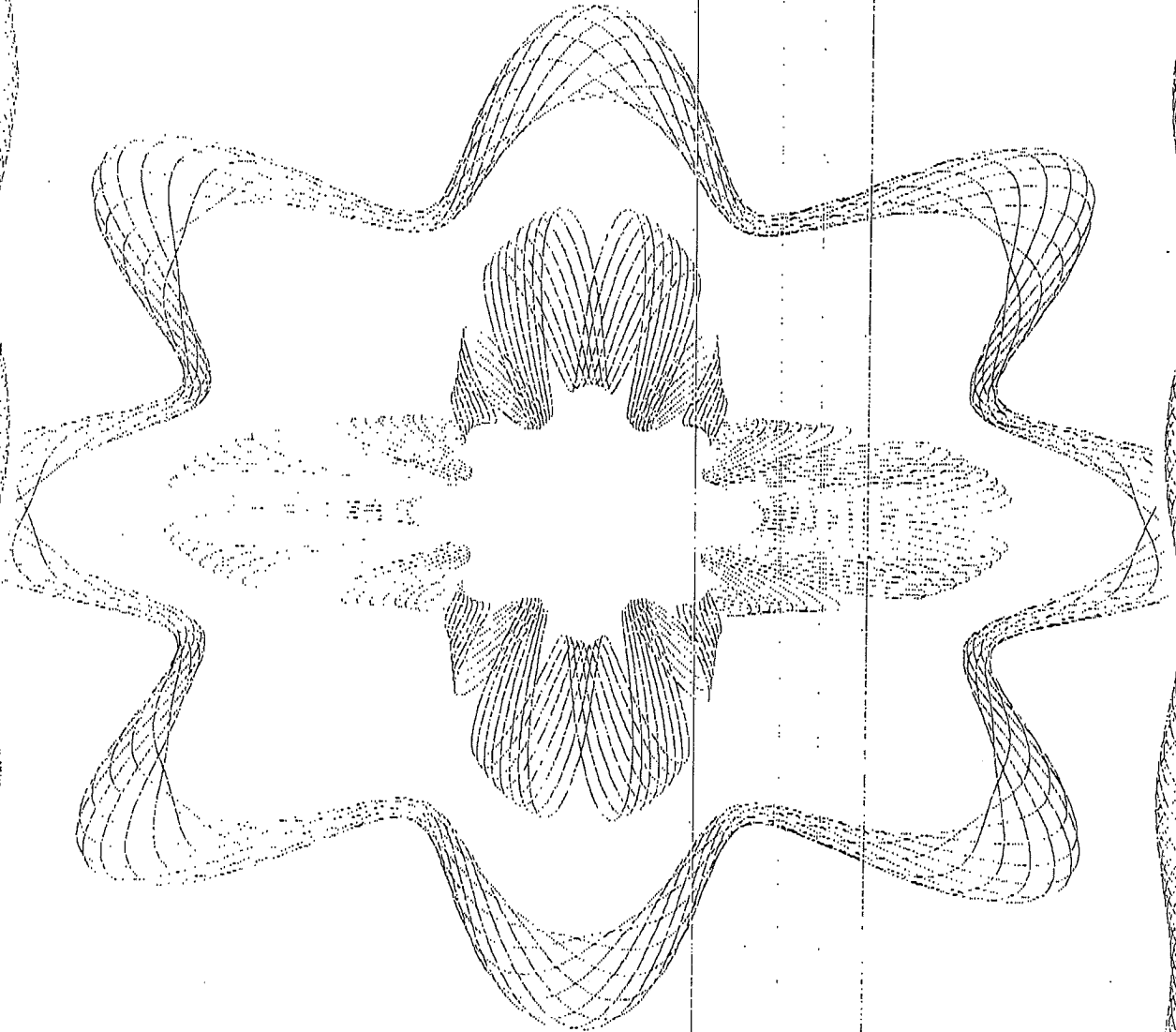

This page is intentionally left blank

Document is exempt

This page is intentionally left blank